

LINCOLN COUNTY CORNER REPORT  
CORNER COMMON TO SECTIONS 16, 17, 20, AND 21 (06-09)  
GCDB 0609300400  
LINCOLN COUNTY GEODETIC CONTROL STATION 83COR  
SHEET 1 OF 2

1880 S.G. CAUDLE GLO CONTRACT 364

SET: POST FOR CORNER TO SECTIONS 16, 17, 20, AND 21, FROM WHICH:

- 36" FIR BEARS N 42° E, 18 LINKS (11.9').
- 10" SPRUCE BEARS S 21° E, 15 LINKS (9.9').
- 5" VINE MAPLE BEARS S 39° W, 17 LINKS (11.2').
- 4" VINE MAPLE BEARS N 23° W, 32 LINKS (21.1').

1887 JEFFERSON D. FENTON SILETZ INDIAN RESERVATION AND GLO CONTRACT 531

FOUND: POST, 4" SQUARE, FIRMLY IN THE GROUND, MARKED "T6S S16" ON NORTHEAST, R9W S21 ON SOUTHEAST, "S 21 BT" (SIC, ACTUALLY S 20), ON SOUTHWEST, AND "S17 BT" ON NORTHWEST FACES, WITH 3 NOTCHES ON SOUTH AND EAST EDGES, FROM WHICH POST:

- 36" FIR MARKED "T6S R9W S16 BT" BEARS N 42° E, 18 LINKS (11.9') (= GLO RECORD).
- 10" SPRUCE MARKED "T6S R9W S21 BT" BEARS S 21° E, 15 LINKS (9.9') (= GLO RECORD).
- 5" VINE MAPLE MARKED "T6S R9W S20 BT" BEARS S 39° W, 17 LINKS (11.2') (= GLO RECORD).
- 4" VINE MAPLE MARKED "T6S R9W S17 BT" BEARS N 23° W, 32 LINKS (21.1') (= GLO RECORD).

1892 W.H. ODELL SPECIAL INSTRUCTIONS MAY 23, 1892

FOUND: CORNER TO SECTIONS 16, 17, 20, AND 21, ON NORTH BOUNDARY OF SILETZ INDIAN RESERVATION, STANDING IN PLACE A FIR POST, 4" SQUARE, SET FIRMLY IN THE GROUND, FROM WHICH THE ORIGINAL BEARING TREES STOOD AS FOLLOWS:

- 48" FIR BEARS N 25° E, 15 LINKS (9.9') (GLO N 42° E, 11.9').
- 18" HEMLOCK BEARS S 20° E, 20 LINKS (13.2') (GLO, SPRUCE S 21° E, 9.9').
- THERE WERE OTHER TREES STANDING NEAR, BUT THEY WERE NOT MARKED AS BEARING TREES.

1904 MORRIS WYGANT GLO CONTRACT NO. 758

FOUND: CORNER OF SECTIONS 16, 17, 20, AND 21, WHICH IS A POST, FIRMLY SET, MARKED AND WITNESSED AS DESCRIBED BY THE SURVEYOR GENERAL.

1983 AND 1984 JAMES W. PROCHNAU CS 10335 AND 10753

FOUND: 1" PIPE (UNKNOWN ORIGIN), FROM WHICH:

- ORIGINAL 54" D. FIR STUMP WITH VISIBLE SCRIBING BEARS N 42° E, 11.9' (= GLO).
- ORIGINAL 24" SPRUCE WITH HEALED FACE BEARS S 2° E, 10.2' (GLO S 21° E, 9.9').
- 38" FIR STUMP WITH SCRIBING "RM" VISIBLE BEARS S 89° W, 31.2' (NO RECORD).

SET: 2 X 30" GALVANIZED IRON PIPE WITH 2-1/2" BRASS CAP MARKED "T6S R9W S17/S16/S20/S21 1983 PLS 1305", FROM WHICH:

NEW:

- 13" HEMLOCK SCRIBED "T6S R9W S17 BT" BEARS N 88° E, 45.4'.
- 5" ALDER BARK SCRIBED "T6S R9W S17 BT" BEARS N 79° W, 18.3'.

1994 CHARLES D. CURTIS CS 14560

FOUND: BRASS CAP STAMPED "SEC. 16 SW. T. 6 S., R. 9 W. 1983 PLS 1305".

2006 CHARLES A. DENISON CS 17781

FOUND: BRASS CAP LS 1305, 1983 AND BT'S PER CS 10753.

2008 LINCOLN COUNTY SURVEYOR'S OFFICE

FOUND: 2-1/2" OUTSIDE DIAMETER GALVANIZED IRON PIPE, 0.8' ABOVE GRADE, WITH 2-1/2" BRASS CAP MARKED "T6S R9W S17/S16/S20/S21 1983 PLS 1305", FROM WHICH:

- ORIGINAL 54" D. FIR STUMP 6' TALL WITH OPEN BLAZE AND PARTIAL SCRIBING "6S S16" VISIBLE BEARS N 42° E, 11.9' (= GLO).
- ORIGINAL 34" SPRUCE WITH NO VISIBLE BLAZE AND ALUMINUM TAG MARKED "N 2° E, 10.2" BEARS S 2° E, 10.2' (= CS 10335).
- 17" HEMLOCK WITH MOSTLY HEALED DOUBLE BLAZE, ILLEGIBLE SCRIBING, AND ALUMINUM LOCATOR TAG MARKED "S 89°W, 45.4" BEARS N 88° E, 45.4' (= CS 10335).
- 30" FIR STUMP WITH SCRIBING "RM" VISIBLE ON LOOSE SLAB BEARS S 89° W, 31.2' (= CS 10335).
- 10" ALDER WINDFALL STUMP 3' TALL BUT LEANING 70° FROM VERTICAL TOWARDS THE NORTHWEST, BARK SCRIBING "BT" VISIBLE, BEARS N 79° W, 18.3' (= CS 10335).
- STEEL T-POST BEARS NORTH, 1'.

NEW:

- 5/8" X 30" IRON ROD AT GRADE, WITH 2" YELLOW PLASTIC CAP MARKED "LINCOLN COUNTY SURVEY", 23' SOUTHEAST OF CENTERLINE OF GAS LINE ROAD BEARS N 28°20'40" E, 114.72'. 1" WHITE PVC PIPE 4' TALL 1' NORTH.

REGISTERED  
PROFESSIONAL  
LAND SURVEYOR

*Tom Hamilton*

OREGON  
JULY 13, 1979  
THOMAS R. HAMILTON  
PLS #1816

RENEWAL DATE: JUNE 30, 2009

LINCOLN COUNTY CORNER REPORT  
CORNER COMMON TO SECTIONS 16, 17, 20, AND 21 (06-09)  
GCDB 0609300400  
LINCOLN COUNTY GEODETIC CONTROL STATION 83COR  
SHEET 2 OF 2

- 5/8" x 30" IRON ROD AT GRADE, WITH 2" LINCOLN COUNTY ALUMINUM CAP MARKED "LINCOLN COUNTY 83AZ 2009", 12' SOUTHEAST OF CENTERLINE OF GAS LINE ROAD BEARS S 59°24'52" W, 127.07'. CARSONITE POST AND LINCOLN COUNTY SURVEY MARKER TAG 3' NORTH.
- REPAINTED RED BAND ON ALL 1983 BEARING TREES. ADDED LINCOLN COUNTY SURVEY MARKER TAG TO SOUTHWEST 30" FIR STUMP.

CONCLUSION THE PIPE FOUND IS THAT SET BY PROCHNAU IN 1984 AND IS A PERPETUATION OF THE 1880 CAUDLE POSITION.

MEASUREMENTS WERE DONE WITH A LEICA TCA1105 TOTAL STATION, POCKET COMPASS AND STEEL TAPE. BEARINGS ARE GEODETIC, BASED UPON STARNET PROJECT 6-9.PRJ AND THE MAPPING ANGLE OF -2°20'37" AT THE SECTION CORNER.

WITNESSES: PHIL LAMBERSON,  
JOE EDWARDS

LINCOLN COUNTY SURVEYOR'S OFFICE  
880 NE 7TH ST.  
NEWPORT, OREGON 97365  
(541)-265-4147

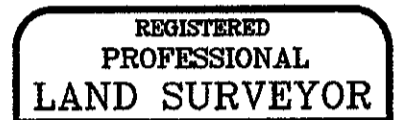
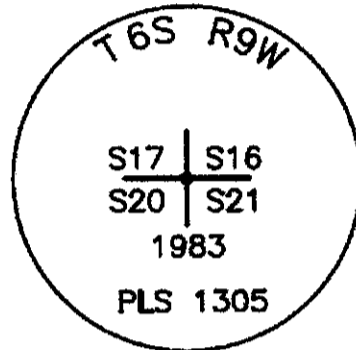

*Tom Hamilton*

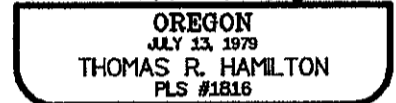

RENEWAL DATE: JUNE 30, 2009

